



imageRUNNER ADVANCE DX C5800 Series

CONNECT SECURELY, TRANSFORM DIGITALLY

OPTIMUM PERFORMANCE AND UNRIVALLED USER EXPERIENCE FROM INNOVATIVE TECHNOLOGIES

The future of business is digital. Canon imageRUNNER ADVANCE DX is the new generation of smart multifunction devices, designed to support and accelerate every step of your digital transformation. Built with Canon's imageRUNNER ADVANCE DNA, state-of-the-art technology and software work hand-in-hand to digitise, automate and optimise content-centric workflows.

Canon's imageRUNNER ADVANCE DX C5800 Series is even faster, introducing 70 ppm print speed combined with 270 ipm scanning. Boosting this heightened productivity even further, improved media handling supports smaller paper type formats and enhanced finishing capabilities. uniFLOW Online Express, which comes as standard, delivers cloud connectivity and print management, while intuitive document processing delivers a seamless user experience for digitising documents. Work flexibly from anywhere with quick installation and easy maintenance, plus quieter overall operation and improved sustainability.



PRODUCTIVITY



SECURITY

McAfee
PROTECTED



SUSTAINABILITY



**CLOUD
CONNECTIVITY**



SERVICEABILITY



Canon uniFLOW Online
Outstanding Cloud Output Management Solution



New to the Line



Canon uniFLOW Online
Outstanding Cloud Output Management Solution

Canon

imageRUNNER ADVANCE DX C5800 Series

PRODUCTIVITY

- Fast printing and scanning with up to 70 ppm print and 270 ipm scan speeds.
- Cloud-based features like Filing Assist from uniFLOW Online* accelerate digital transformation with automatic document filing.
- Anti-streak, multi-feed detection, and blank page removal reduce processing time and improve scan performance.
- Reactive first copy output minimises downtime for users and improves productivity for print and scan jobs.
- User maintenance videos make it easy for users to manage quick fixes, such as clearing paper jams.
- Minimal device interaction is enabled through the Canon PRINT Business app or integrated timeline on the Home UI, which streamline frequently used processes and maintain productivity with flexible hybrid working.
- Greater support for mixed paper types reduces manual preparation tasks and allows batch scanning of different sizes.
- Enhanced Eco Staple finishing reduces preparation and management time for documents.

CLOUD CONNECTIVITY

- Scan and print documents from any location with enhanced cloud connectivity, offered with re-usable print formats for ease of use.
- Cloud-based software-as-standard uniFLOW Online Express (uFOE) offers a single integrated solution to increase device security and simplify print management.

*uniFLOW Online is available as a Device Based Cloud Subscription for Document Output and Capture Management. Based on business needs, users can upgrade to uniFLOW Online to unlock a range of advanced benefits, including: Increased security with user authentication methods. Personalised workflows to enhance productivity. Reduced wastage by releasing jobs at the device. An intuitive cloud dashboard to leverage real-time data. Greater control over access and usage to reduce print costs.

NOTE – Certain features are only enabled with the combination of imageRUNNER ADVANCE DX and uniFLOW Online

QUICK FACTS

- **Format:** Colour A3
- **Paper Supply Capacity (Max):** 6,350 sheets
- **Warm-up time:** 4 seconds or less
- **Finishing Capabilities:** Collate, Group, Offset, Staple, Saddle Stitch, Hole Punch, Eco Staple, Staple On Demand
- **Supported File Types:** PDF, EPS, TIFF, JPEG, and XPS
- **Optional:** EFI Fiery Embedded

- **Print speed:** 40-70 ppm
- **Scan speed:** 270 ipm (A4)
- **Print Languages:** UFR II, PCL6, Adobe® PostScript 3™
- **Print Resolution:** 1,200 x 1,200

- Lighter device weight reduces installation time, so users can start using the device more quickly.
 - Easy maintenance and less downtime from a combination of applying the best features and technology in our imageRUNNER DX portfolio.
 - The Installation Support Service applies setting information from a cloud database during installation, so users can start operating devices earlier.
- ## SUSTAINABILITY
- Less energy consumption, less weight, and less noise reduce the device environmental impact.
 - Faster sleep recovery includes 4-second quick start-up mode and 6-second power on, using less energy and making operational cost savings.
 - Quieter operation is maintained when printing from all paper drawers and two-sided printing, ensuring less noise disruption in office environments.
 - Better TEC value minimises running costs, particularly in a fleet environment, providing a 15% reduction in energy consumption compared to previous models.
 - Enhanced toner technology features a lower melting point, so less energy is used when the device is active.
 - Lighter device weight supports sustainability by reducing materials in manufacturing and downsizing transportation requirements.

TAILORED SOLUTIONS TO MEET EVERY CHALLENGE

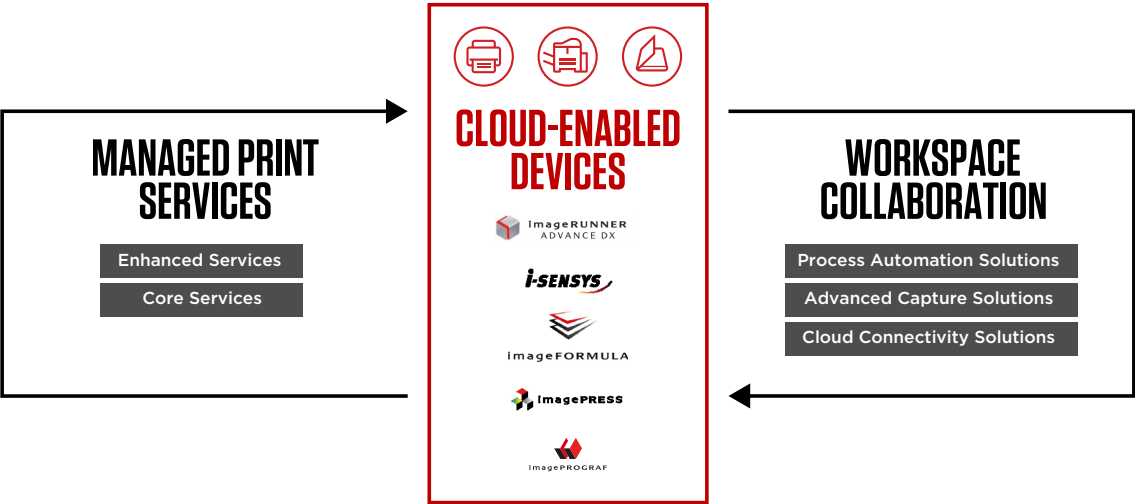

Canon's Digital Transformation Services (DTS), bring together our leading hardware and software into an integrated technology ecosystem, designed to support your transformation journey. This offering combines Managed Print Services and Workspace Collaboration solutions, to help you gain transparency and control over the entire document lifecycle.



Canon Ireland
3006 Lake Drive
Citywest, Saggart
Co. Dublin, Ireland
Telephone No: 01 2052400
Facsimile No: 01 2052525
canon.ie

Canon (UK) Ltd
5 The Square
Stockley Park
Uxbridge
UB11 1ET
Tel: 01895 648 000
www.canon.co.uk

Canon Inc.
canon.com
Canon Europe
canon-europe.com
English edition
© Canon Europa N.V., 2021

imageRUNNER ADVANCE DX C5800 Series

POWERFUL PRODUCTIVITY FROM SECURE COLOUR A3 MULTIFUNCTION DEVICES



Canon uniFLOW Online
Outstanding Cloud Output Management Solution



Canon uniFLOW Online
Outstanding Cloud Output Management Solution



New to the Line

MAIN CONFIGURATION OPTIONS

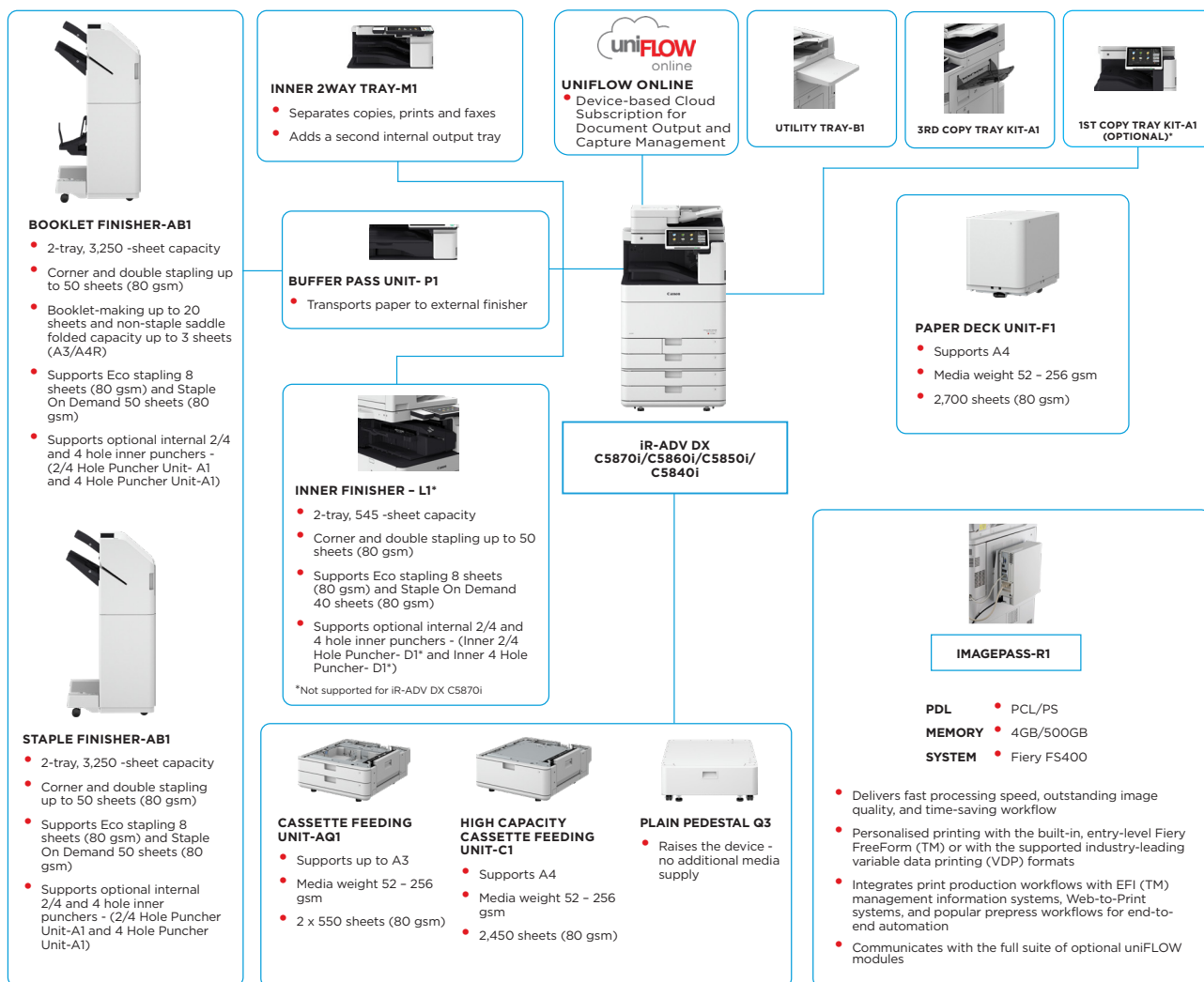

This flat configuration is for illustration purpose only. For a complete list of options and the exact compatibility relationships, please refer to the [online product configurator](#).

The Unified Firmware Platform (UFP) ensures that the latest feature upgrades and protection are available, for an enhanced user experience across the entire iR ADVANCE DX portfolio.

*To support Sustainability and save on raw materials required for plastics, 1st Copy Tray Kit-A1 is optional.

Canon

imageRUNNER ADVANCE DX C5800 Series

Canon

TECHNICAL SPECIFICATIONS

imageRUNNER ADVANCE DX C5800 Series

File Format	TIFF, JPEG, PDF (Limited Color, Compact, Searchable, Apply policy, Optimize for Web, PDF/A-1b, Trace & Smooth, Encrypted, Device Signature, User Signature), XPS(Compact, Searchable, Device Signature, User Signature), Office Open XML (PowerPoint, Word)	Power consumption	Maximum: Approx. 2,000 W (iR-ADV DX C5870i) Approx. 1,800 W (iR-ADV DX C5860i/C5850i/C5840i) Copying (with DADF continuous scan): Approx. 943 W ^{*1} Standby: Approx. 53.4 W ^{*1} Sleep mode: Approx. 0.8 W ^{*2} ^{*1} Reference value: measured one unit ^{*2} 0.8 W is not available in all circumstances due to certain settings.
Universal Send Features	Original Type Selection, Two-sided Original, Book to Two Pages, Different-size Originals, Density Adjustment, Sharpness, Copy Ratio, Erase Frame, Job Build, Delayed Send, Preview, Job Done Notice, File Name, Subject/Message, Reply-to, E-mail Priority, TX Report, Original Content Orientation, Skip Blank Pages		Typical Electricity Consumption (TEC) [*] : iR-ADV DX C5870i: 0.86 kWh iR-ADV DX C5860i: 0.71 kWh iR-ADV DX C5850i: 0.58 kWh iR-ADV DX C5840i: 0.46 kWh [*] As per USA Energy Star 3.0
FAX SPECIFICATIONS		Noise levels (BW/CL)	Sound Power Level (LWA,m) Active (BW) (1-sided) iR-ADV DX C5870i: 66 dB*, Kv 3 dB* iR-ADV DX C5860i: 64 dB*, Kv 3 dB* iR-ADV DX C5850i: 62 dB*, Kv 3 dB* iR-ADV DX C5840i: 61 dB*, Kv 3 dB* [*] Reference value: measured only one unit with ISO7779, described with ISO9296 (2017)
Maximum Number of Connection Lines	(Optional) 2 (2nd line optional)		Sound Pressure (LpAm) Bystander's position: Active (BW/CL) (1-sided) iR-ADV DX C5870i: 52 dB*/52 dB* iR-ADV DX C5860i: 50 dB*/51 dB* iR-ADV DX C5850i: 48 dB*/49 dB* iR-ADV DX C5840i: 47 dB*/47 dB*
Modem Speed	Super G3: 33.6 kbps G3: 14.4 kbps		Stand-by iR-ADV DX C5870i/C5860i/C5850i: 23 dB* [*] Reference value: measured only one unit with ISO7779, described with ISO9296 (2017)
Compression Method	MH, MR, MMR, JBIG	Standards	Blue Angel
Resolution (dpi)	400 x 400 (Ultra Fine), 200 x 400 (Super Fine), 200 x 200 (Fine), 200 x 100 (Normal)	CONSUMABLES	
Sending/Receiving Size	Sending: A3, A4, A4R, A5 ^{*1} , A5R ^{*1} , B4, B5 ^{*2} , B5R ^{*1} Receiving: A3, B4, A4, A4R, A5R, B5, B5R ^{*1} Sent as A4 ^{*2} Sent as B4 short	Toner Cartridges	C-EXV 58 Toner BK/C/M/Y C-EXV 58L Toner C/M/Y
FAX memory	Up to 30,000 pages (2,000 jobs)	Toner Yield	C-EXV 58 Toner BK: 71,000 pages C-EXV 58 Toner C/M/Y: 60,000 pages C-EXV 58L Toner C/M/Y: 26,000 pages
Speed dials	Max. 200	(Estimated Yield @5% coverage)	
Group dials/destinations	Max. 199 dials	SOFTWARE AND PRINTER MANAGEMENT	For detailed information please visit our website https://www.canon-europe.com/business/
Sequential broadcast	Max. 256 addresses	Tracking and reporting	Universal Login Manager (ULM) uniFLOW Online Express [*]
Memory backup	Yes		[*] For more information, please refer to uniFLOW Online Express uniFLOW Online
Fax Features	Sender's Name (TTI), Selecting the Telephone Line (when sending fax), Direct Send, Delayed Send, Preview, Job Done Notice, TX Report, Interrupt Transmission, Sequential Broadcasting, Password/Subaddress Sending, Confidential Mailbox, 2 on 1 Log	Remote management tools	iWEMC eMaintenance Content Delivery System Network ScanGear Canon Driver Configuration Tool MEAP (Multifunctional Embedded Application Platform) Kofax PowerPDF Advanced (Optional)
STORE SPECIFICATIONS		Scanning software	
Mail Box (Number supported)	100 User Inboxes, 1 Memory RX Inbox, 50 Confidential Fax Inboxes Maximum 10,000 Pages (2,000 jobs) Stored	Optimisation tools	For full specifications & options, please visit the Canon website
Advanced Space	Communication Protocol: SMB or WebDAV Supported Client PC: Windows [*] 8.1/10 Concurrent Connections (Max.): SMB:64, WebDAV:3 Standard:16 GB (With option: max. 480GB)	Platform	Optional on all models
Advanced Space available disc space	Standard:16 GB (With option: max. 480GB)	Document Publishing	imagePASS-R1 (Embedded) 1200 x 1200, 600 x 600
Advanced Space Features:	Authentication for Advanced Space Log-in, Sort Function, Printing a PDF File with a Password, imageWARE Secure Audit Manager Support, Search, File Preview, Authentication Management, Open to public, URI TX, Backup/Restore	FIERY PRINT CONTROLLER SPECIFICATIONS (EMBEDDED)	Adobe PS3,PCL6 4GB (1x4GB) 500 GB SATA Intel Pentium G4400 (3.3GHz) FS400
SECURITY SPECIFICATIONS		Name	
Authentication and Access Control (Activation is required)	User Authentication (Picture Login, Picture and PIN Login, Card Login [*] , Username and Password Login, Function Level Login, Mobile Login), Department ID Authentication (Department ID and PIN Login, Function Level Login), uniFLOW Online Express (PIN Login, Picture Login, Picture and PIN Login, Card Login [*] , Card and PIN Login, Username and Password Login, Department ID and PIN Login, Function Level Login), Access Management System (Access Control) [*] Card readers are optional, please refer to Hardware Accessories	Print Resolution (dpi)	
Document Security	Print Security (Secure Print, Encrypted Secure Print, Forced Hold Printing, uniFLOW Secure Print ^{*)} , Receive Data Security (Confidential Fax Inbox Forwarding Received Documents Automatically), Scan Security (Encrypted PDF, Device Signature PDF/XPS, User Signature PDF/XPS, Adobe LiveCycle [*] Rights Management ES2.5 Integration), BOX Security (Mail Box Password Protected, Advanced Space Access Control), Send Data Security (Setting for requesting password input per transmission, Restricted E-mail/File send functions, Confirming FAX number, Allow/Restrict Fax Driver Transmissions, Allow/Restrict Sending from History, S/MIME Support), Document Tracking (Secure Watermark) ^{*1} Requires uniFLOW Online / uniFLOW	Page Description Language(s)	
Network Security	TLS 1.3, IPsec, IEEE802.1X authentication, SNMP V3.0, Firewall Functionality (IP/MAC Address Filtering), Dual Network Support (Wired LAN/Wireless LAN, Wired LAN/Wired LAN), Disabling Unused Functions (Enabling/Disabling Protocols/Applications, Enabling/Disabling Remote UI, Enabling/Disabling USB Interface), G3 FAX separation from LAN, USB Port separation from LAN, Prohibit the execution of files stored in Advanced Box in the MFP, Scan and Send -Virus Concerns for E-mail Reception	Memory	
Device Security	Protecting SSD Data (SSD Data Encryption (FIPS140-2 Validated), SSD Lock, Standard SSD Initialize, Trusted Platform Module (TPM 2.0), Job Log Conceal Function, Protecting MFD Software Integrity, Checking MFD Software Integrity (Verify System at Startup, Runtime Intrusion Detection), HCD-PP [*] [*] Certification will follow post launch of this Series	Hard Disk Drive	
Device Management and Auditing	Administrator Password, Digital Certificate And Key Management, Audit Log, Cooperating with External Security Audit System (Security Information and Event Management), Image Data Logging, Security Policy Setting	Processor Speed	
ENVIRONMENTAL SPECIFICATIONS		System	
Operating Environment	Temperature: 10 to 30 °C Humidity: 20 to 80 % RH (Relative Humidity)	PAPER SUPPLY OPTIONS	
Power source	220-240 V, 50/60 Hz, 6 A	Cassette Feeding Unit-AQ1	Paper Capacity: 2 x 550 sheets (80 gsm) Paper Type: Thin, Plain, Recycled, Color, Heavy, Bond, Transparency, Pre-punched, Letterhead Paper Size: A3, A4, A4R, A5, A5R, A6R, B4, B5, B5R Custom size: 98.0 x 148.0 mm to 304.8 x 457.2 mm Paper Weight: 52 to 256 gsm Dimensions (W x D x H): 620 x 660 x 251 mm (attached to the main unit) Weight: Approx. 22 kg Paper Capacity: 2,450 sheets (80 gsm) Paper Type: Thin, Plain, Recycled, Color, Heavy, Bond, Pre-punched, Letterhead Paper Size: A4 Paper Weight: 52 to 256 gsm Dimensions (W x D x H): 620 x 660 x 251 mm (attached to the main unit) Weight: Approx. 29 kg Paper Capacity: 2,700 sheets (80 gsm) Paper Type: Thin, Plain, Color, Recycled, Heavy, Pre-punched Paper Size: A4, B5 Paper Weight: 52 to 256 gsm Dimensions (W x D x H): 344 x 630 x 440 mm (attached to the main unit) Weight: Approx. 31 kg [*] Paper capacity may vary with different paper type/size. Capacity (with 80gsm paper): A4, A5, A5R, A6R, B5: 250 sheets SRA3, A3, A4R, B4, B5R: 100 sheets Paper Weight: 52 to 300 gsm
		High Capacity Cassette Feeding Unit-C1	
		Paper Deck Unit-F1	
		OUTPUT OPTIONS [*]	
		1st Copy Tray Kit-A1	



TECHNICAL SPECIFICATIONS

imageRUNNER ADVANCE DX C5800 Series

Inner 2way Tray-M1	<p>Tray Capacity (with 80 gsm paper) Upper tray: A4, A5, A5R, A6R, B5: 100 sheets SRA3, A3, A4R, B4, B5R: 50 sheets</p> <p>Lower tray: A4, A5, A5R, A6R, B5: 100 sheets SRA3, A3, A4R, B4, B5R: 100 sheets</p> <p>Paper Weight: 52 to 300 gsm Dimensions (W x D x H): 428 x 405 x 88 mm Weight: Approx. 0.7 kg</p>	Booklet Finisher-AB1	<p>(Requires Buffer Pass Unit-P1) (Includes the above Staple Finisher-AB1 basic staple specifications.) Saddle Stitch paper size: A3, A4R, B4 Saddle Stitch Staple Capacity: 20 sheets x 10 sets (52 to 81.4 gsm) (including 1 cover sheet 52 to 256 gsm) Non Staple Folded Bunch Capacity: up to 3 sheets (52 to 105 gsm) Dimensions (W x D x H): 637 x 623 x 1,142 mm (when the extension tray is extended) Weight: Approx. 57 kg (Requires the Inner Finisher-L1) Two or Four Holes Acceptable Punch Paper Weight: 52 to 300 gsm Acceptable Punch Paper Size: Two holes: A3, A4, A4R, A5, B4, B5, B5R Four holes: A3, A4 (Requires the Inner Finisher-L1) Four Holes Acceptable Punch Paper Weight: 52 to 300 gsm Acceptable Punch Paper Size: Four holes: A3, A4, A4R, A5, B4, B5, B5R (Requires either the Staple Finisher-AB1 or Booklet Finisher-AB1) Two or Four Holes Acceptable Punch Paper Weight: 52 to 300 gsm Acceptable Punch Paper Size: Two holes: A3, A4, A4R, A5, B4, B5, B5R Four holes: A3, A4 (Requires either the Staple Finisher-AB1 or Booklet Finisher-AB1) Four Holes Acceptable Punch Paper Weight: 52 to 300 gsm Acceptable Punch Paper Size: Four holes: A3, A4, A4R, A5, B4, B5, B5R</p>
3rd Copy Tray Kit-A1	<p>Capacity (with 80gsm paper): A4, A5R, B5: 100 sheets A3, A4R, B4, B5R: 75 sheets Paper Weight: 52 to 300 gsm Dimensions (W x D x H): 442 x 373 x 176 mm (attached to the main unit, when the extension tray is extended) Weight: 0.5 kg</p>	Inner 2/4 Hole Puncher-D1 (Not supported for iR-ADV DX C5870i)	
Inner Finisher-L1 (Not supported for iR-ADV DX C5870i)	<p>Tray Capacity (with 80gsm paper): Upper Tray: SRA3, A3, A4, A4R, A5, A5R, A6R, B4, B5, B5R: approx 45 sheets Lower Tray: A4, A5, A5R, B5: approx. 500 sheets, SRA3, A3, A4R, B4, B5R: 250 sheets, A6R: 30 sheets Envelope: 10 sheets</p> <p>Paper Weight: 52 to 300 gsm Staple Position: Corner, Double Staple Capacity: (52 to 90 gsm paper) A4, B5: 50 sheets A4R: 40 sheets A3, B4: 30 sheets Eco Staple*: A4, B5: 10 sheets (52 to 64 gsm) 8 sheets (65 to 81.4 gsm) 6 sheets (82 to 105 gsm) A3, B4: 5 sheets (52 to 64 gsm) 4 sheets (65 to 81.4 gsm) 3 sheets (82 to 105 gsm)</p> <p>Staple On Demand: 40 sheets (80 gsm) Dimensions (W x D x H): 743 x 525 x 225 mm (attached to the main unit, when the extension tray is extended) Weight: Approx. 9.1 kg * Large size media A3/B4 support will be available from March 2021 when an update to the firmware is applied: A3*: 8 sheets (52 to 64 gsm) 8 sheets (65 to 81.4 gsm) 6 sheets (82 to 105 gsm)</p>	Inner 4 Hole Puncher-D1 (Not supported for iR-ADV DX C5870i)	
		2/4 Hole Puncher Unit-A1	
		4 Hole Puncher Unit-A1	
		HARDWARE ACCESSORIES	
		Card Readers	<p>Various card readers available e.g. MiCard Plus. Please contact local Canon Office for more details. Copy Card Reader Attachment-B7 IC Card Reader Box for Numeric Keypad-A1 Copy Card Reader-F1 Printer Cover-M2 Tab Feeding Attachment-F1 Buffer Pass Unit-P1 Utility Tray-B1 Numeric Keypad-A2</p>
		Others	
		SECURITY OPTIONS	
		Data Security	<p>256GB SSD-A1 1TB SSD-A1 Memory Mirroring Kit-A1</p>
		SYSTEM AND CONTROLLER OPTIONS	
		Print Accessories	<p>PCL International Font Set-A1 Barcode Printing Kit-D1 imagePASS-R1 Hot Folders License Fiery Compose Fiery Impose Fiery Impose and Compose NFC Kit-E2 Serial Interface Kit-K3 Copy Control Interface Kit-A1 Connection Kit-A3 for Bluetooth LE Super G3 FAX Board-AX1 Super G3 2nd Line Fax Board-AX1 Remote Fax Kit-A1 IP FAX Expansion Kit-B1</p>
		Barcode Printing	
		EFI-Fiery Based Controller	
		EFI-Fiery Based Controller Options	
		System Accessories	
		Fax Accessories	
		OTHER OPTIONS	
		Accessibility Accessories	<p>ADF Access Handle-A1 Voice Guidance Kit-G1 Voice Operation Kit-D1 Staple Cartridge-Y1 (2 x 2,000pcs)* Staple-P1 (2 x 5,000pcs) *For Booklet Finisher only</p>
		Consumables	
Staple Finisher-AB1	<p>(Requires Buffer Pass Unit-P1) Tray Capacity (with 80gsm paper): Upper Tray: A4, A5, A5R, A6R, B5: approx. 250 sheets, SRA3, A3, A4R, B4, B5R: approx. 125 sheets</p> <p>Lower Tray: A4, A5, A5R, B5: 3,000 sheets, SRA3, A3, A4R, B4, B5R: 1,500 sheets, A6R: 250 sheets Envelopes: Monarch: 30 sheets, COM10 No.10, DL, ISO-C5: 100 sheets</p> <p>Paper Weight: Upper Tray 52 to 256 gsm, Lower Tray 52 to 300 gsm Staple Position: Corner, Double Staple Capacity: (52 to 90 gsm) A4, B5: 50 sheets A4R: 40 sheets A3, B4: 30 sheets Eco Staple*: A4: 10 sheets (52 to 64 gsm) 8 sheets (65 to 81.4 gsm) 6 sheets (82 to 105 gsm) A3: 5 sheets (52 to 64 gsm) 4 sheets (65 to 81.4 gsm) 3 sheets (82 to 105 gsm)</p> <p>Staple On Demand: 50 sheets (52 to 90 gsm) Dimensions (W x D x H): 637 x 623 x 1,142 mm (when the extension tray is extended) Weight: Approx. 31 kg * Large size media A3 support will be available from March 2021 when an update to the firmware is applied A3*: 10 sheets (52 to 64 gsm) 8 sheets (65 to 81.4 gsm) 6 sheets (82 to 105 gsm)</p>		

Software & Solutions



Certifications and compatibility



Canon Ireland
3006 Lake Drive
Citywest, Saggart
Co. Dublin, Ireland
Telephone No: 01 2052400
Facsimile No: 01 2052525
canon.ie

Canon (UK) Ltd
5 The Square
Stockley Park
Uxbridge
UB11 1ET
Tel: 01895 648 000
www.canon.co.uk

Canon Inc.
canon.com
Canon Europe
canon-europe.com
English edition
© Canon Europa N.V., 2020

